

## 9541 X2

**Max. 50 A**

**New!**

### CHARGER FOR LEAD ACID BATTERIES

**12V: 2 x 25A**

**12V: 1 x 50A**

**24V: 25A**

- 2 kanals lader
- 3-trinns ladekontroll med timer
- Switch mode, høy virk.grad (83%)
- Temperaturkompensert ladespenning -tempføler plassert utvendig
- Uavhengig av nettspenningsvariasjoner
- Polvendings- og kortslutningssikker
- Alarm, reléutgang
- 2 channel charger
- 3-step charge control with timer
- Switch mode, high efficiency (83%)
- Temperature compensated charge voltage - heat sensor located externally
- Unaffected by fluctuations in mains voltage
- Protected against reverse polarity and short circuit proof
- Alarm, relay

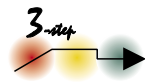

<b>Foreløpige Tekniske data</b>	<b>Preliminary Technical specifications</b>	
Inngangsspenning:	Input voltage:	198-264 VAC, 47-63 Hz
Ladekontroll:	Chargecontrol:	3 step IUU
Ladespenning	Charge voltage	
• Cycle mode:	• Cycle mode:	14,7 V
• Standby mode:	• Standby mode:	13.7 V
Temperaturkoeffisient:	Temperature coefficient:	-3 to -4mV/°C pr cell
Timer*:	Timer*:	4 h +/- 30min.
Ladestrøm:	Charge current:	25A
Max strømtrekk fra batteri ved frakoblet nett:	Leakage current from battery with mains switched off:	< 0,5mA 12 V
Rippel:	Ripple:	< 100 mV p-p
Virkningsgrad (v. 100% last):	Efficiency (at 100% load)	> ca 83%
Switchefrekvens ca.:	Switch frequency approx.:	67 kHz
Temperaturområde:	Temperature range:	
•Drift:	•Operating:	-25 to +40 °C
•Lagring:	•Storage:	-25 to +85 °C
Beskyttelse:	Protection:	
Kortslutningssikker	Short circuit proof	
Polvendingsikker	Against reversed polarity	
Overtemperaturbeskyttelse	Overtemperature protection	
Sikkerhet:	Safety:	EN 60335-2-29
Isolasjonsklasse :	Insulation class:	I
Isolasjonsspenning:	Insulation voltage:	
• Primær - jord:	• Primary - ground:	1500 VAC
• Primær - sekundær:	• Primary - secondary:	4000 VAC
• Sekundær - jord:	Secondary - ground:	500 VAC
EMC standarder:	EMC standards:	
• Emisjon	• Emission	EN 60000-6-3
• Immunitet	• Immunity	EN 61000-6-1, EN 55014
Indikasjon:	Indication:	3 fargers lysdiode - 3 colour LED
• Rød (konstantstrøm):	• Red (Constant current):	25 A
• Gul (Konstant spenning timer):	• Yellow (Constant voltage timer):	14,7 V
• Grønn (Konst. spenning, standby):	• Green (Constant voltage, standby):	13.7 V
Nettilkobling:	Mains connection:	Nettledning
Utgangsterminal:	Terminals:	Skruterminaler Screw terminals
IP-Grad:	IP-Grade:	20
Mål (LxBxH)	Dimesions (LxWxH)	289x115x153 mm
Weight:	Weight:	4 kg

\* timer leveres også med andre tider \* timer is also available with other values

09102006

**www.mascot.no**  
**sales@mascot.no**  
**Phone:**  
**Fax:**

**Main Office**  
PO Box 177  
N-1601 FREDRIKSTAD  
NORWAY  
+47 69 36 43 00  
+47 69 36 43 01

**Mascot UK**  
Box 2090, Salisbury  
Wiltshire SP2 2BH  
UK  
+44 1722 504 853  
+44 845 299 1210

**Mascot DE-AT-CH-BENELUX**  
Hirschbergstr. 28/7  
D-74838 LIMBACH  
GERMANY  
+49 6287 95140  
+49 6287 95141

Tettninger Str. 52  
D-88239 WANGEN  
GERMANY  
+49 7528 95 16 77  
+49 7528 95 16 78

**Mascot France**  
38 rue Leo Lagrange  
94270 Le Kremlin Bicêtre  
FRANCE  
+33 1 46 58 71 85  
+33 1 46 58 71 85