

GP Batteries

Data Sheet

Rechargeable Nickel Metal Hydride Battery

Model: GP125AAMT

Revision History

Revision	Date	Initiator	Change Description
00	2011-08-29	Jackie Yu	1. Charge to RCM document No. Besides, the service life is changed from >350 cycles to >500 cycles .
01	2012-05-31	Jackie Yu	1. Charge the weight to 24.0g
02	2014-05-23	Jackie Yu	1. New form

Prepared by	Checked by	Approver
RD Engineer	RD Manager	SM
Lizzy Li	Jackie Yu	Vivian Fong
Date: 2014-05-23	Date: 2014-05-23	Date: 2014-05-23

GPI International Limited

Gold Peak Building, 8/F, 30 Kwai Wing Road,
Kwai Chung, New Territories, Hong Kong.
Tel: (852) 2484 3333 Fax: (852) 24805912
Email: gpii@goldpeak.com
Website: <http://www.gpbatteries.com>

Model No.: GP125AAMT

Type	: High Temperature Rechargeable Nickel Metal Hydride Cylindrical Cell
Nominal Dimension (with Sleeve)	: $\Phi = 14.4\text{mm}$ H = 48.2mm
Applications	: Long term standby use. Recommended discharge current: 125mA to 625mA
Nominal Voltage	: 1.2V
Capacity	: Nominal: 1250mAh Minimum: 1250mAh Typical: 1280mAh When discharged at 250mA to 1.0V at 20°C
Charging Condition	: Standard mode: 125mA for 16 hrs at 20°C Standby Intermittent mode: 125mA for 16hrs at 20°C then maintenance with 125mA for 1min/10mins.
Service Life	: >500 cycles (IEC standard)
Continuous Overcharge	: Comply with IEC standard Permanent Charge Endurance Test
Weight	: 24.0g
Internal Resistance	: Average 23m Ω upon fully charged (Max. 30m Ω) at 1000Hz
Max. Charging Voltage	: 1.6V at 125mA charging
Ambient Temperature Range	: Charge: 0 to 50°C Discharging: -20 to 70°C Storage: -20 to 35°C Storage (1 week): -20 to 60°C

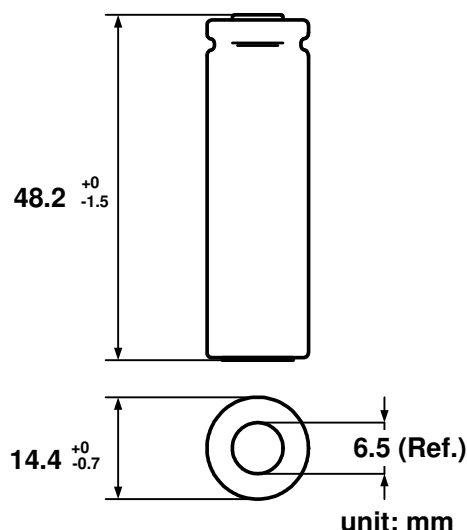

Low Rate Discharge

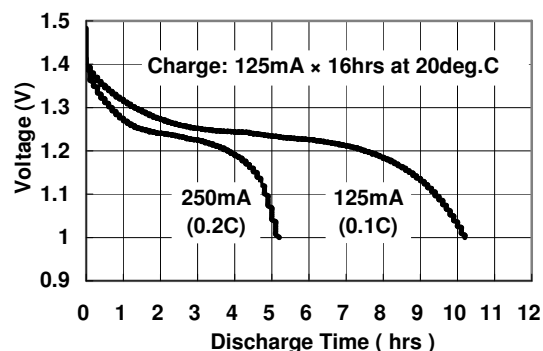

Charge & Discharge efficiency Vs. temp.

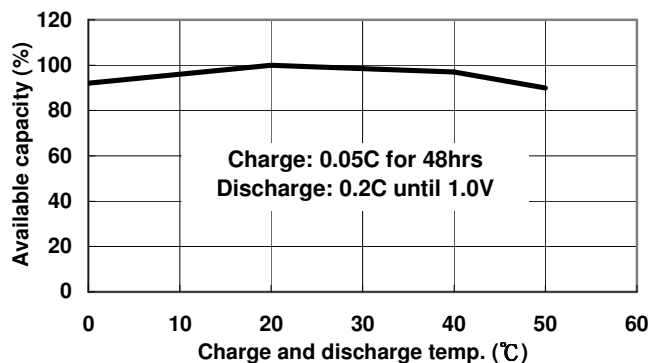

High Rate Discharge

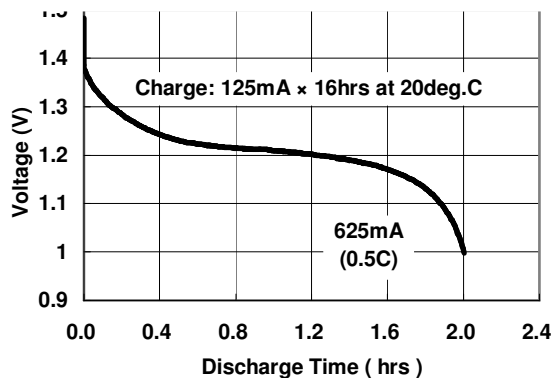

The information (subject to change without prior notice) contained in this document is for reference only and should not be used as a basis for product guarantee or warranty. For applications other than those described here, please consult your nearest GP Sales and Marketing Office or Distributors.